

## 1.0 DIMENSIONAL DRAWING

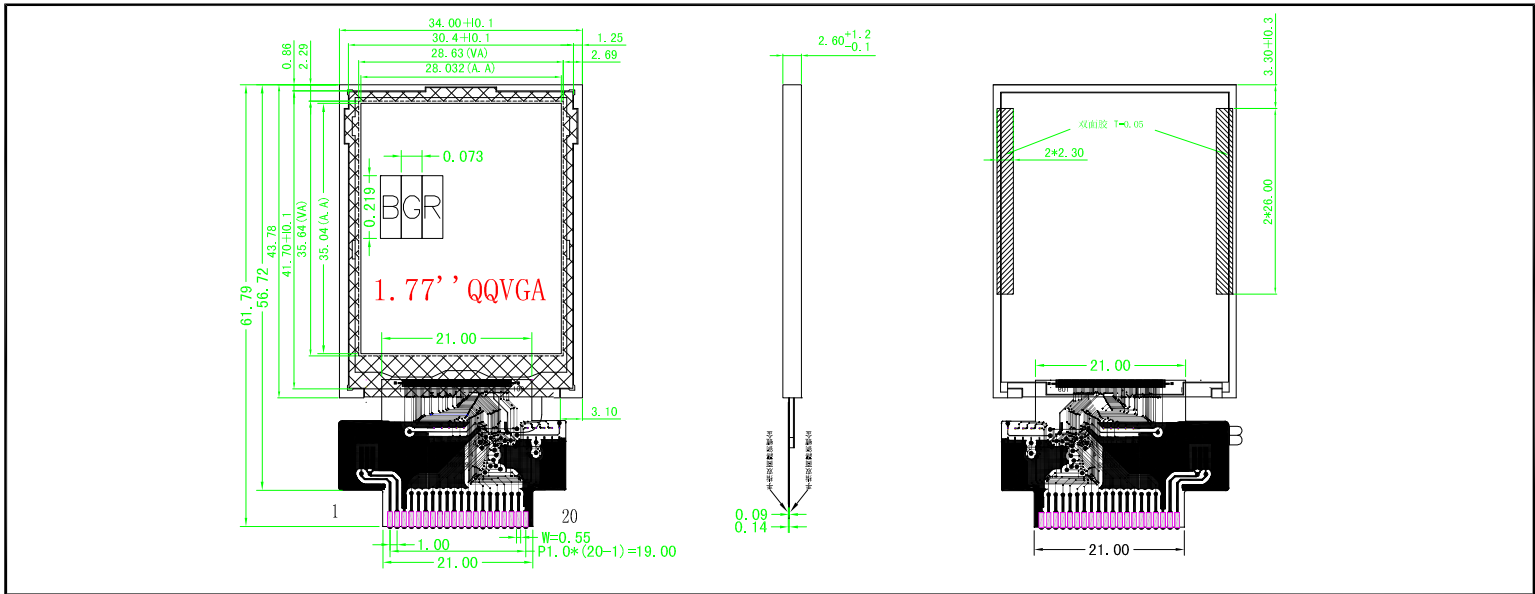

## 2.0 BLOCK DIAGRAM & POWER SUPPLY

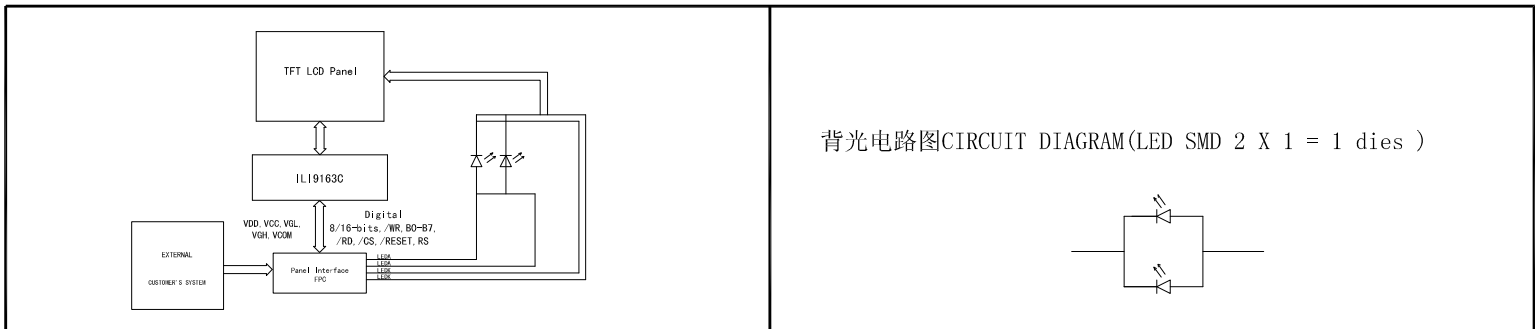

## 3.0 MECHANICAL SPECIFICATIONS & FEATURE

Item	Nominal Dimensions (mm)	Feature	
		Active Screen Size	177" Diagonal
Module Size(W*H*T)	43.78×34.0×2.6	Resolution	128(RGB)×160
Active Area(W*H)	35.64 × 28.62	View Angle	6 O'clock
Dot × Dot(W*H)	128(RGB) × 160	Pixel Driving Element	α-Si TFT
Dot Pitch(W*H)	---	Pixel Arrangement	RGB Vertical Stripe
Dot Size(W*H)	0.219(H)x0.219(V)	Driving IC	IL19163C
---	---	Operating Temperature	-20. C to +70. C
---	---	Storage Temperature	-30. C to +80. C

## 4.0 ELECTRICAL CHARACTERISTICS

Item	Symbol	Test Condition	Min.	Typ.	Max.	Unit
LED Supply Voltage	LEDA	AGND=GND=0V Ta=25. C	3.0	3.2	3.5	V
Digital Supply Voltage	VCC	AGND=GND=0V Ta=25. C	1.65	1.8	3.3	V
Analog Supply Voltage	VDD	AGND=GND=0V Ta=25. C	2.5	2.8	4.8	V

## 5.0 INTERFACE PIN CONNECTIONS

Pin No.	Symbol	I/O	Function	Remarks
1	LEDK	P	Power for LED backlight(anode)	
2	LEDA	P	Power for LED backlight(Cathode)	
3	GND	I	Power ground	TYP(1.8V)
4	VCC	P	Power for digital circuit	TYP(2.8V)
5	VDD	P	Power for analog circuit	
6	NC	-	No Connection	
7	CS	I	LCM selection pin for serial interface;internal pull high	
8	RES	I	LCM reset pin.internal pull high.connected to VDD when not used	
9	RS	I	LCM Data/Command Selection Terminal	
10	/WR	I	LCM Write Signal Input Terminal	
11	RD	I	LCM Read Signal Input Terminal	
12--19	D7---D0	I	Input data	
20	GND	I	Power ground	